

SECTION 2-2
(1:100)

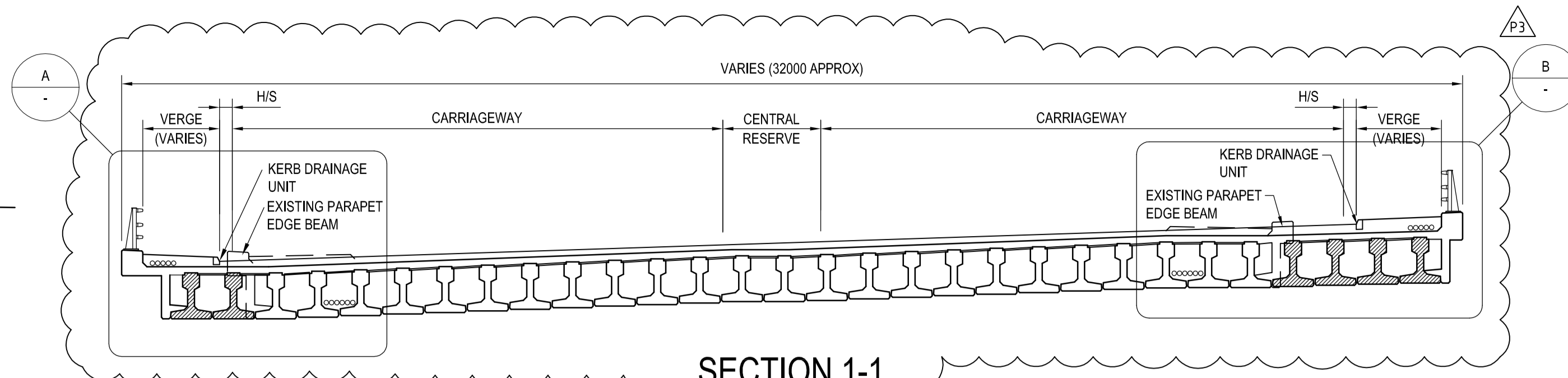

SECTION 1-1
(1:100)

- | SUGGESTED CONSTRUCTION SEQUENCE SOUTH WEST CORNER OF BR-001 | SUGGESTED CONSTRUCTION SEQUENCE NORTH WEST CORNER OF BR-001 | SUGGESTED CONSTRUCTION SEQUENCE NORTH EAST CORNER OF BR-001 | SUGGESTED CONSTRUCTION SEQUENCE SOUTH EAST CORNER OF BR-001 |
|---|--|---|--|
| <ol style="list-style-type: none"> WORKS TO BE UNDERTAKEN DURING PHASE 4 OF STAGE 2 TEMPORARY TRAFFIC MANAGEMENT PLAN, OPTION C. TO MINIMISE LANE OCCUPATIONS ON THE WESTLINK, A PILING PLATFORM SHALL BE FORMED BETWEEN THE NORTH PERIMETER WALL OF THE POLICE STATION AND THE EXISTING WESTLINK ALIGNMENT. THIS SHALL REQUIRE A COMBINATION OF SELECTED GRANULAR MATERIAL AND GABION WALLING (OR SIMILAR) TO BE FORMED ON THE PEDESTRIAN WALKWAY AND POSSIBLY PART OF NORTH QUEEN STREET. ALSO, THE EXISTING POLICE STATION WALL SHALL REQUIRE WALINGS AND PROPPING, OR STRENGTHENING USING GABIONS OR SIMILAR. A SHEET PILE WALL SHALL BE PROVIDED AROUND THE PLAN EXTENT OF THE NEW WORKS, AVOIDING ANY EXISTING WORKS. PILOT HOLES SHALL BE DRILLED TO CONFIRM THE EXTENT OF THE FOUNDATIONS TO THE POLICE STATION BOUNDARY WALL. DESIGN CHANGE TO THE NEW WINGWALL MAY BE REQUIRED. ONCE THE SHEET PILES HAVE BEEN INSTALLED, EXCAVATE AROUND EXISTING ABUTMENT, DEMOLISH EXISTING SW WINGWALL AND REMOVE FROM SITE. IT MAY BE PREFERABLE TO REMOVE THE RETAINING WALL CURRENTLY SUPPORTING THE PEDESTRIAN WALKWAY TO ACHIEVE THIS. INSTALL DOWELS IN EXISTING ABUTMENT. CONSTRUCT ABUTMENT EXTENSION. CONSTRUCT NEW SW WINGWALL. REMOVE EXISTING PARAPET EDGE BEAM. INSTALL PRESTRESSED BEAMS. FORM DECK AND NEW PARAPET EDGE BEAM. COMPLETE EARTHWORKS AND FINISHES, INCLUDING REINSTATEMENT OF RETAINING WALL FOR PEDESTRIAN WALKWAY IF REQUIRED. | <ol style="list-style-type: none"> WORKS TO BE UNDERTAKEN DURING PHASE 4 OF STAGE 2 TEMPORARY TRAFFIC MANAGEMENT PLAN, OPTION C. TO MINIMISE LANE OCCUPATIONS ON THE WESTLINK, A PILING PLATFORM SHALL BE FORMED ADJACENT TO THE EXISTING WESTLINK ALIGNMENT, NORTH-WEST OF THE BRIDGE. THIS SHALL REQUIRE A COMBINATION OF SELECTED GRANULAR MATERIAL AND GABION WALLING AND A CLOSURE OF THE PEDESTRIAN FOOTPATH AND STAIRS AREA. A SHEET PILE WALL SHALL BE PROVIDED ALONG THE EDGE OF THE EXISTING WESTLINK ALIGNMENT TO ALLOW THE ABUTMENT EXTENSION TO BE FORMED. ONCE THE SHEET PILES HAVE BEEN INSTALLED, EXCAVATE AROUND EXISTING ABUTMENT, DEMOLISH EXISTING NW WINGWALL AND REMOVE FROM SITE. INSTALL DOWELS IN EXISTING ABUTMENTS. CONSTRUCT ABUTMENT EXTENSION. CONSTRUCT NEW NW WINGWALL. REMOVE EXISTING PARAPET EDGE BEAM. INSTALL PRESTRESSED BEAMS. FORM DECK AND NEW PARAPET EDGE BEAM. COMPLETE EARTHWORKS AND FINISHES, NOTING THE INTERFACE WITH RETAINING WALL RW-001 AND INCLUDING ANY REINSTATEMENT WORKS TO EXISTING FOOTPATH AND STEPS AREAS. | <ol style="list-style-type: none"> WORKS TO BE UNDERTAKEN DURING PHASE 4 OF STAGE 2 TEMPORARY TRAFFIC MANAGEMENT PLAN, OPTION C. A SHEET PILE WALL IS REQUIRED ALONG THE EDGE OF THE EXISTING WESTLINK ALIGNMENT TO ALLOW THE ABUTMENT EXTENSION TO BE FORMED. THIS WILL REQUIRE A PARTIAL CLOSURE OF THE WESTLINK. IT MAY BE PREFERABLE TO UNDERTAKE THIS WORK AFTER THE BRIDGE HAS BEEN EXTENDED SOUTHWARDS, ALLOWING ADDITIONAL SPACE FOR RE-ORGANISATION OF LANES. ONCE THE SHEET PILES HAVE BEEN INSTALLED EXCAVATE AROUND EXISTING ABUTMENT, DEMOLISH EXISTING NE WINGWALL AND REMOVE FROM SITE. INSTALL DOWELS IN EXISTING ABUTMENTS. CONSTRUCT ABUTMENT EXTENSION. CONSTRUCT NEW NE WINGWALL. INSTALL PRESTRESSED BEAMS. FORM DECK AND NEW PARAPET EDGE BEAM. COMPLETE EARTHWORKS AND FINISHES, NOTING THE INTERFACE WITH RETAINING WALL RW-003. | <ol style="list-style-type: none"> WORKS TO BE UNDERTAKEN DURING PHASE 4 OF STAGE 2 TEMPORARY TRAFFIC MANAGEMENT PLAN, OPTION C. TO MINIMISE LANE OCCUPATIONS ON THE WESTLINK, A PILING PLATFORM SHALL BE FORMED ADJACENT TO THE EXISTING WESTLINK ALIGNMENT, SOUTH-EAST OF THE BRIDGE. THIS SHALL REQUIRE A COMBINATION OF SELECTED GRANULAR MATERIAL AND GABION WALLING (OR SIMILAR) AND A CLOSURE TO THE PEDESTRIAN FOOTPATH AND PART OF GREAT GEORGE'S STREET. A SHEET PILE WALL SHALL BE PROVIDED AROUND THE PLAN EXTENT OF THE NEW WORKS, AVOIDING ANY EXISTING WORKS AND THE EXISTING GREAT GEORGE'S STREET RETAINING WALL. ONCE THE SHEET PILES HAVE BEEN INSTALLED EXCAVATE AROUND EXISTING ABUTMENT, DEMOLISH EXISTING SE WINGWALL AND REMOVE FROM SITE, NOTING SPECIAL REQUIREMENTS FOR MEMORIAL. ALSO, NOTE THAT ALTHOUGH EXISTING WING WALL IS SEPARATE FROM THE EXISTING ABUTMENT, THE TWO STRUCTURES SHARE THE SAME FOUNDATION SLAB. HYDRO-DEMOLITION IS REQUIRED TO REMOVE THE EXISTING FOUNDATION TO THE WING WALL. INSTALL DOWELS IN EXISTING ABUTMENTS. CONSTRUCT ABUTMENT EXTENSION, TYING REINFORCEMENT INTO EXISTING REINFORCEMENT EXPOSED BY HYDRO-DEMOLITION. CONSTRUCT NEW SE WINGWALL. REMOVE EXISTING PARAPET EDGE BEAM. INSTALL PRESTRESSED BEAMS. FORM DECK AND NEW PARAPET EDGE BEAM. COMPLETE EARTHWORKS AND FINISHES, NOTING THE INTERFACE WITH RETAINING WALL RW-005. REINSTATE MEMORIAL. |

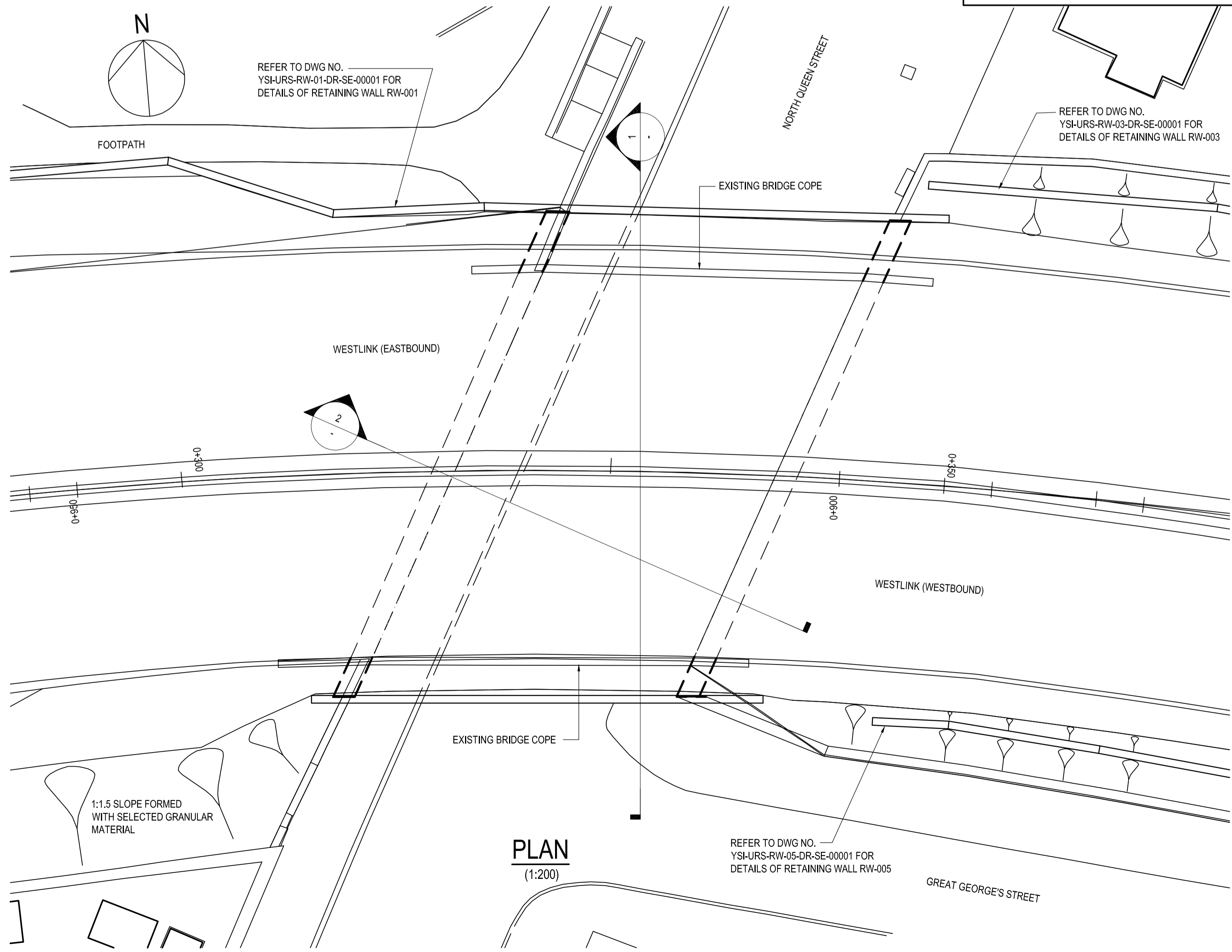

PLAN
(1:200)

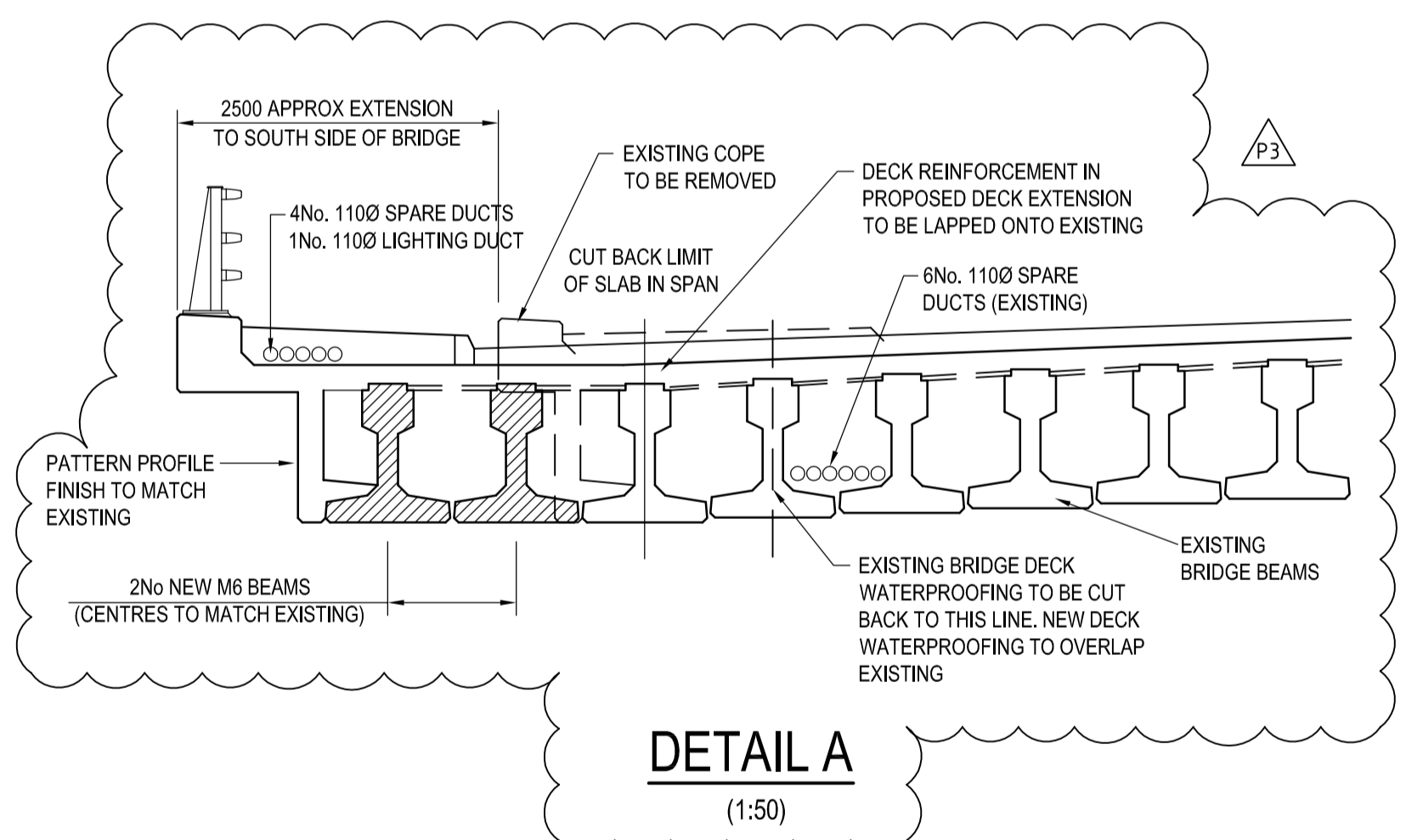

DETAIL A
(1:50)

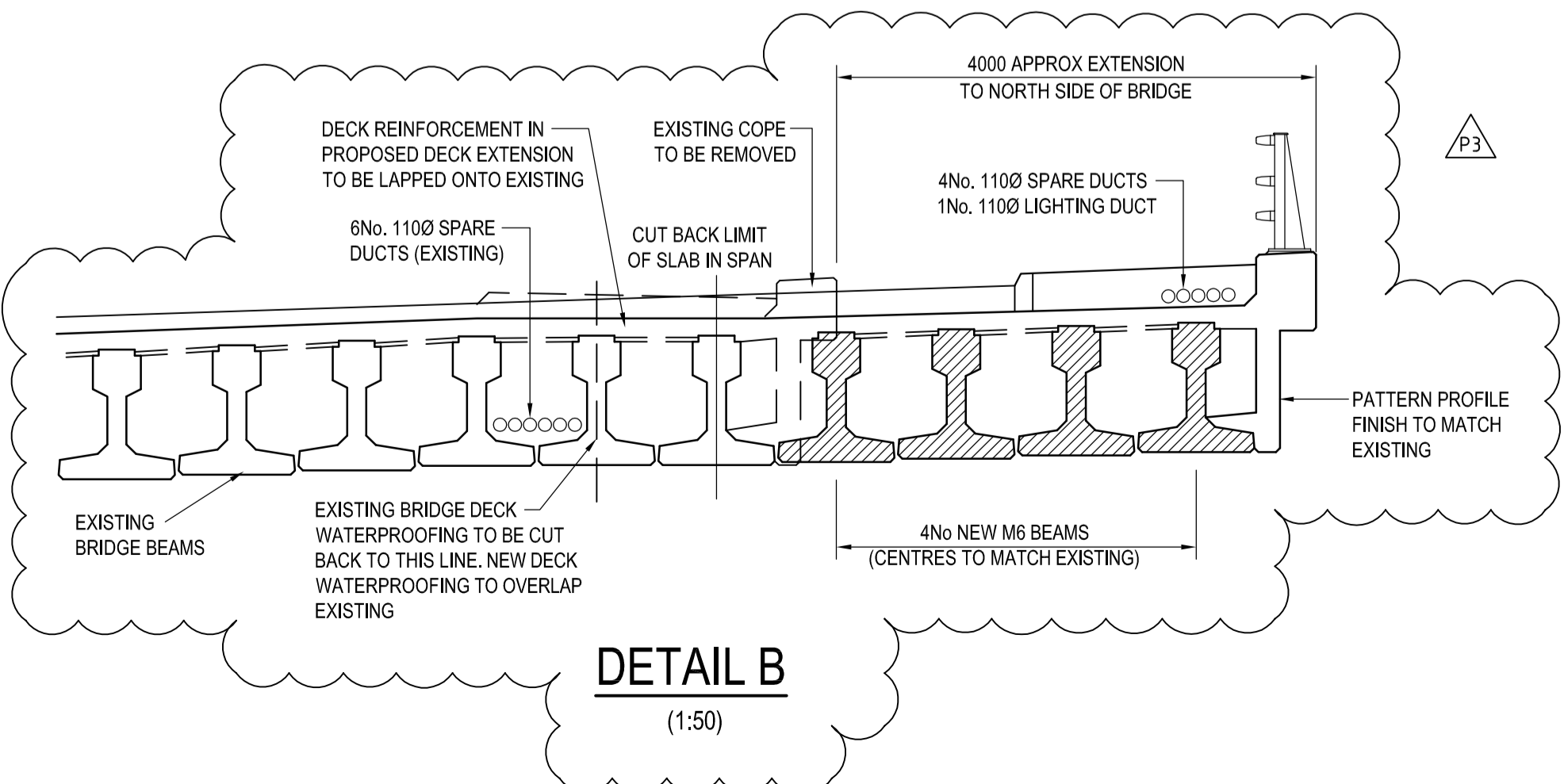

DETAIL B
(1:50)

SAFETY, HEALTH AND ENVIRONMENTAL INFORMATION BOX

IT IS ASSUMED THAT ALL WORKS ON THIS DRAWING WILL BE CARRIED OUT BY A COMPETENT CONTRACTOR WORKING, WHERE APPROPRIATE, TO AN APPROPRIATE METHOD STATEMENT.

THIS DRAWING IS TO BE USED ONLY FOR THE PURPOSE OF ISSUE THAT IT WAS ISSUED FOR AND IS SUBJECT TO AMENDMENT.

NOTES

- THIS DRAWING IS TO BE READ IN CONJUNCTION WITH ALL OTHER RELEVANT DOCUMENTATION.
- DO NOT SCALE FROM THIS DRAWING. USE ONLY PRINTED DIMENSIONS.
- ALL DIMENSIONS IN MILLIMETRES. ALL CHANGES, LEVELS AND COORDINATES ARE IN METRES UNLESS DEFINED OTHERWISE.
- THIS DRAWING IS TO BE READ IN CONJUNCTION WITH THE PROJECT HEALTH & SAFETY FILE FOR ANY IDENTIFIED POTENTIAL RISKS.
- DETAILS ARE REFERENCED THUS:
 - Detail reference
 - Drawing number
 - Blank if shown on this drawing.

| Revision Details | By | Date | Suffix |
|--|-------------|----------|--------|
| SURFACING UPDATED TO MATCH PROPOSED 125 MIN SERVICES SHOWN ON DECK | JMcC DPB | 16.04.14 | P3 |
| RW-002 REMOVED. CONSTRUCTION SEQUENCE UPDATED. | JMcC DPB | 25.02.14 | P2 |
| | DSH DPB | 03.02.14 | P1 |

Purpose of issue

PRELIMINARY



Project Title

YORK STREET INTERCHANGE

Drawing Title

**BRIDGE NO. BR-001 EXTENSION
GENERAL ARRANGEMENT
SHEET 1 OF 2**

| Designated | Drawn | Checked | Approved | Date |
|------------|-------|---------|----------|------|
| DPB | DSH | DPB | | |

URS Internal Project No. _____ Subtitle _____

Scale @ A1
AS SHOWN

Zone _____

THIS DOCUMENT HAS BEEN PREPARED PURSUANT TO AND SUBJECT TO THE TERMS OF URS APPOINTMENT BY ITS CLIENT. URS ACCEPTS NO LIABILITY FOR ANY USE OF THIS DOCUMENT OTHER THAN BY ITS ORIGINAL CLIENT OR FOLLOWING URS' EXPRESS AGREEMENT TO SUCH USE, AND ONLY FOR THE PURPOSES FOR WHICH IT WAS PREPARED AND PROVIDED.

URS Infrastructure & Environment UK Limited
Beech Hill House
Beech Hill Road, Belfast
BT8 7RP
Tel: +44 (0)28 9070 5111
Fax: +44 (0)28 9079 5651
www.ursgroup.com

Drawing Number: **YSI-URS-BR-01-DR-SE-00001** Rev: **P3**

File Name: YSI-URS-BR-01-DR-SE-0001
 File Path: C:\Users\jmc\Documents\Projects\YSI-URS-BR-01-DR-SE-0001

IT IS ASSUMED THAT ALL WORKS ON THIS DRAWING WILL BE CARRIED OUT BY A COMPETENT CONTRACTOR WORKING, WHERE APPROPRIATE, TO AN APPROPRIATE METHOD STATEMENT.

THIS DRAWING IS TO BE USED ONLY FOR THE PURPOSE OF ISSUE THAT IT WAS ISSUED FOR AND IS SUBJECT TO AMENDMENT.

- NOTES
1. THIS DRAWING IS TO BE READ IN CONJUNCTION WITH ALL OTHER RELEVANT DOCUMENTATION.
 2. DO NOT SCALE FROM THIS DRAWING. USE ONLY PRINTED DIMENSIONS.
 3. ALL DIMENSIONS IN MILLIMETRES. ALL CHANGES, LEVELS AND COORDINATES ARE IN METRES UNLESS DEFINED OTHERWISE.
 4. THIS DRAWING IS TO BE READ IN CONJUNCTION WITH THE PROJECT HEALTH & SAFETY FILE FOR ANY IDENTIFIED POTENTIAL RISKS.

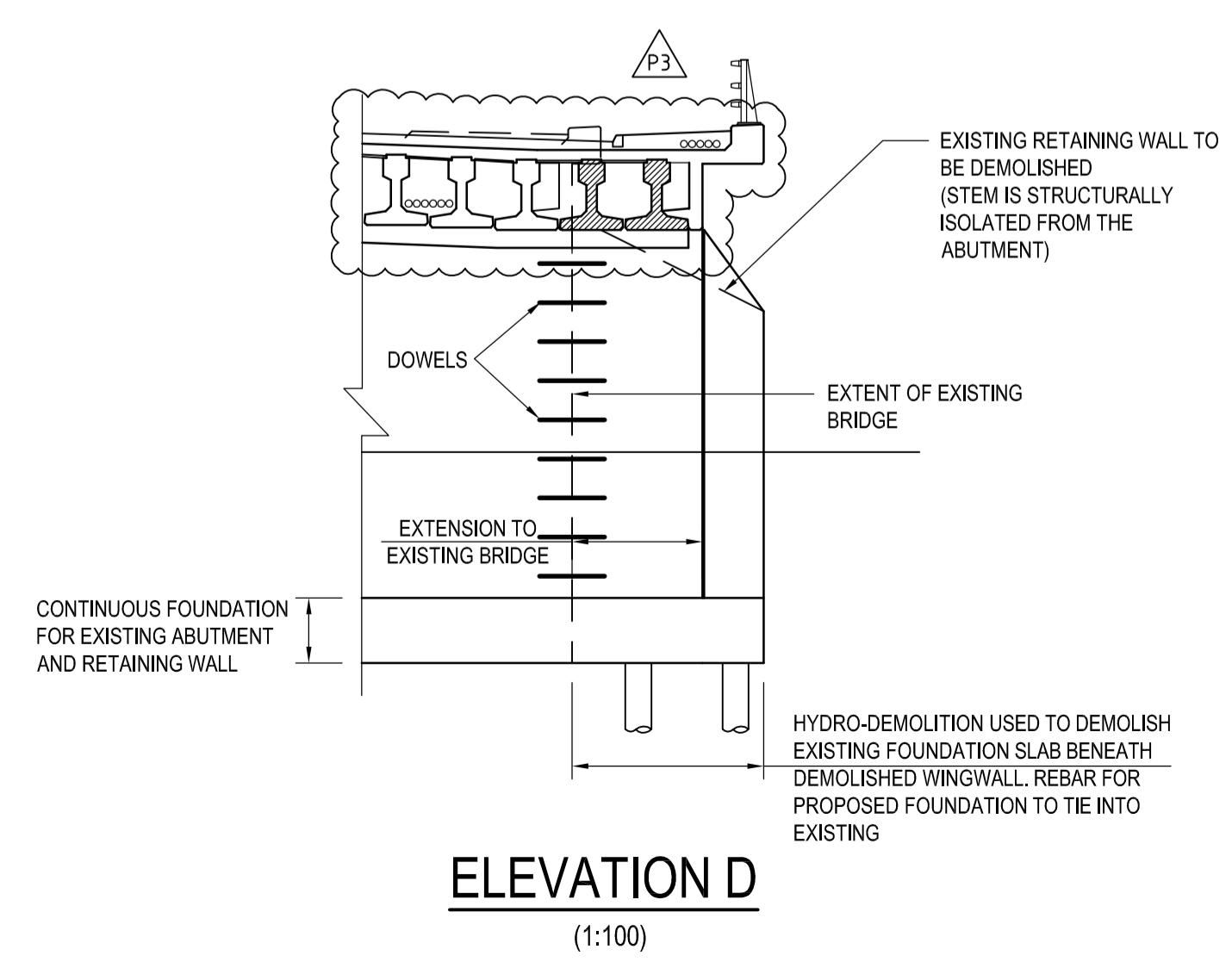
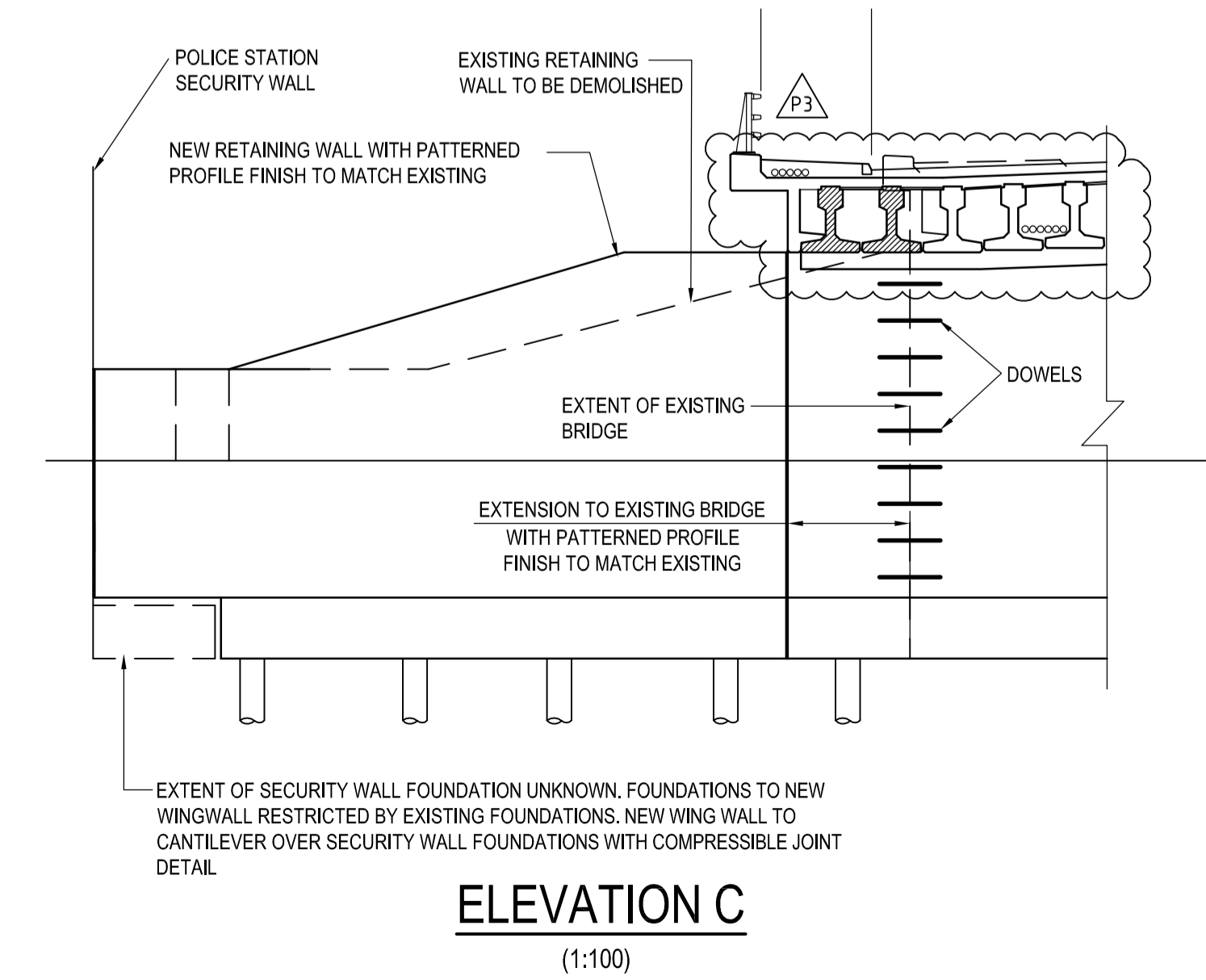
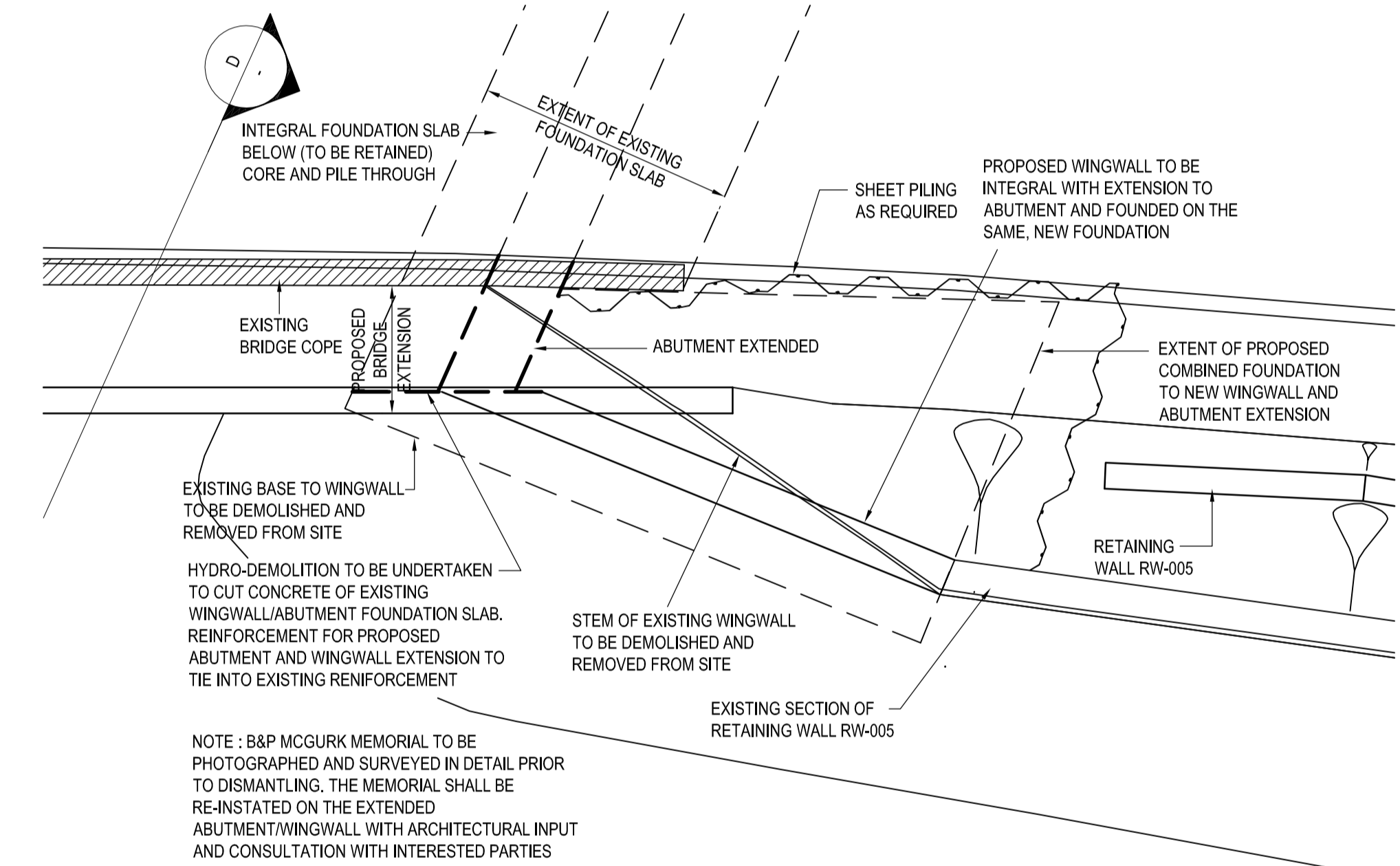
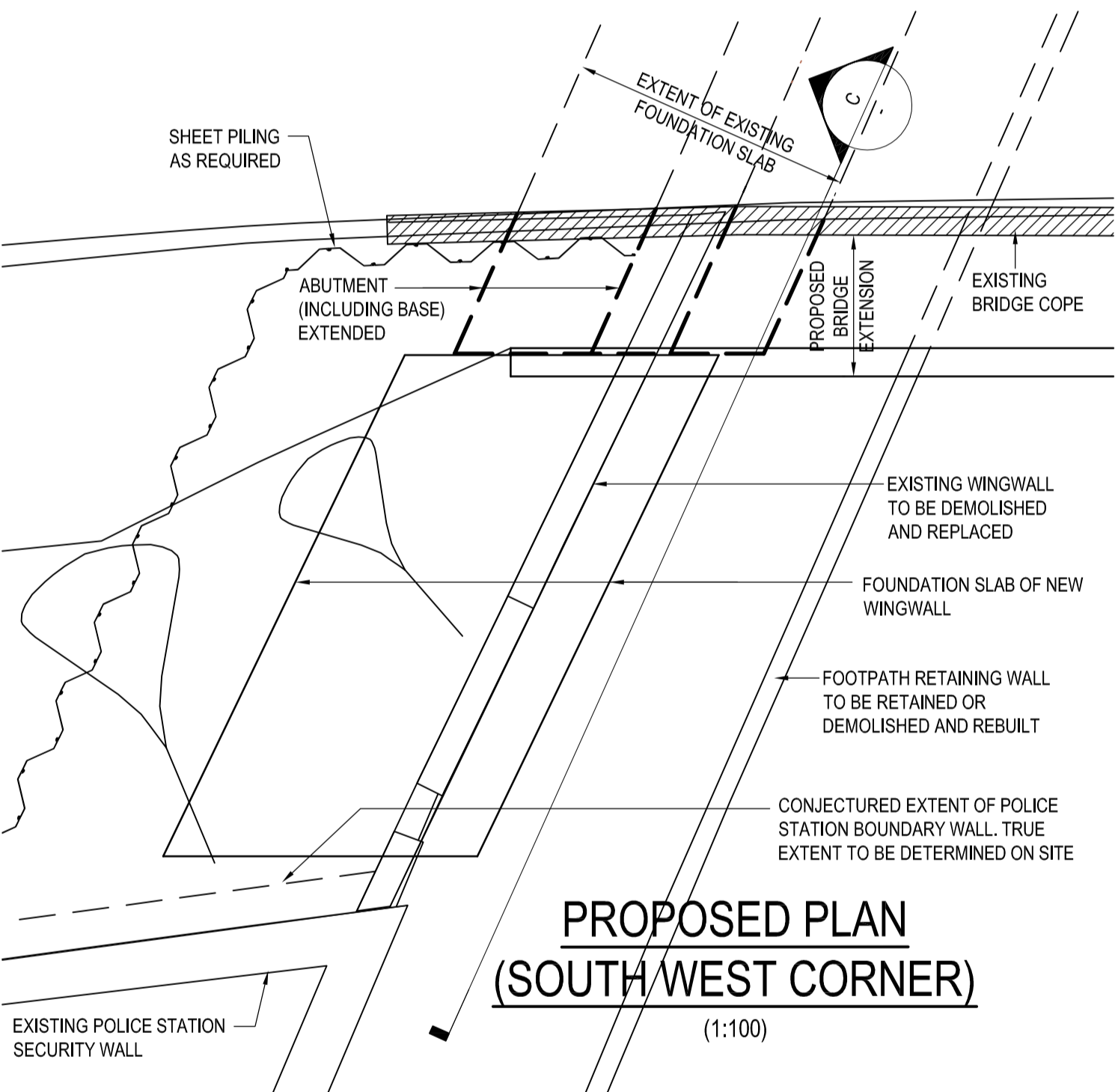
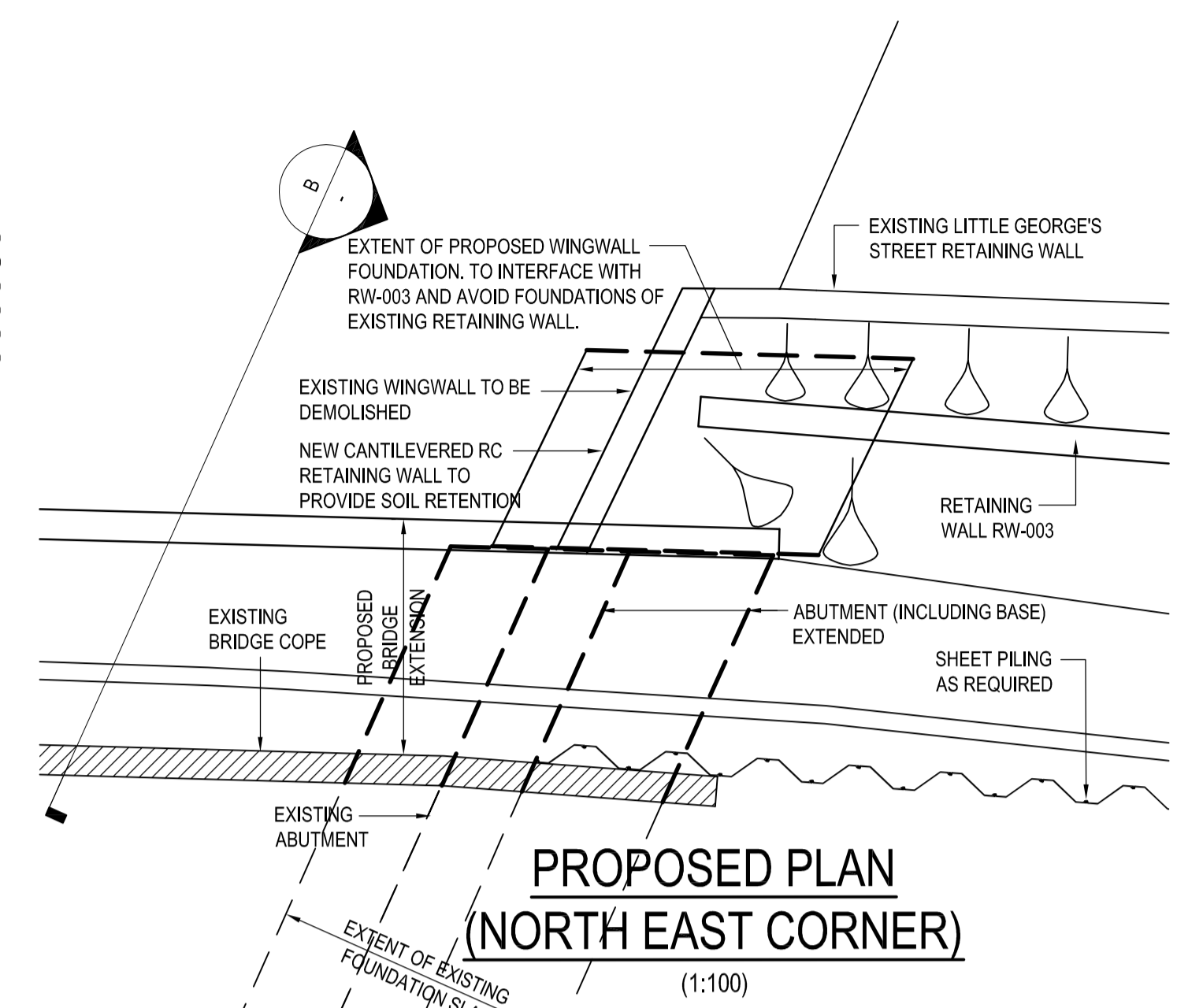
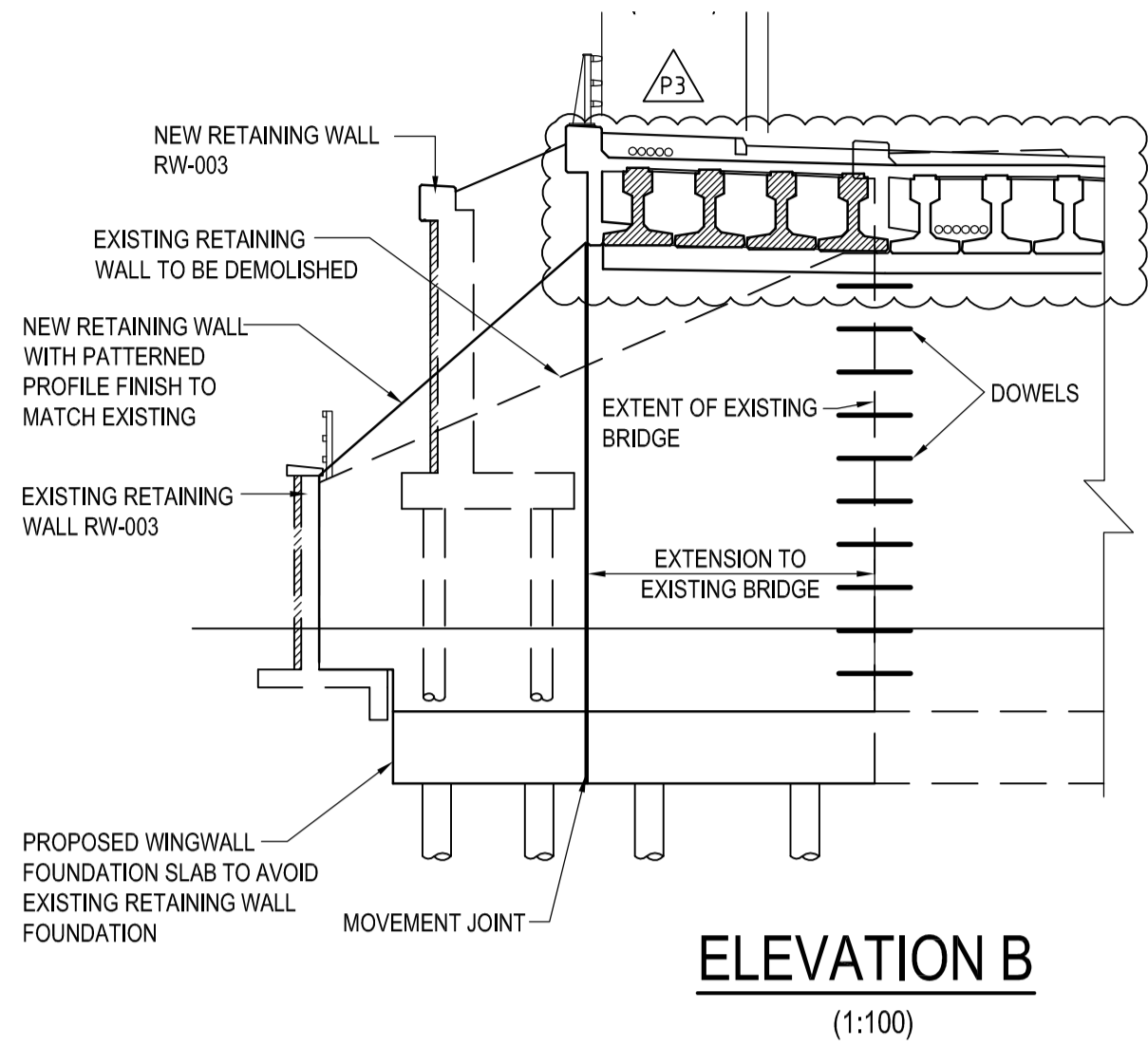
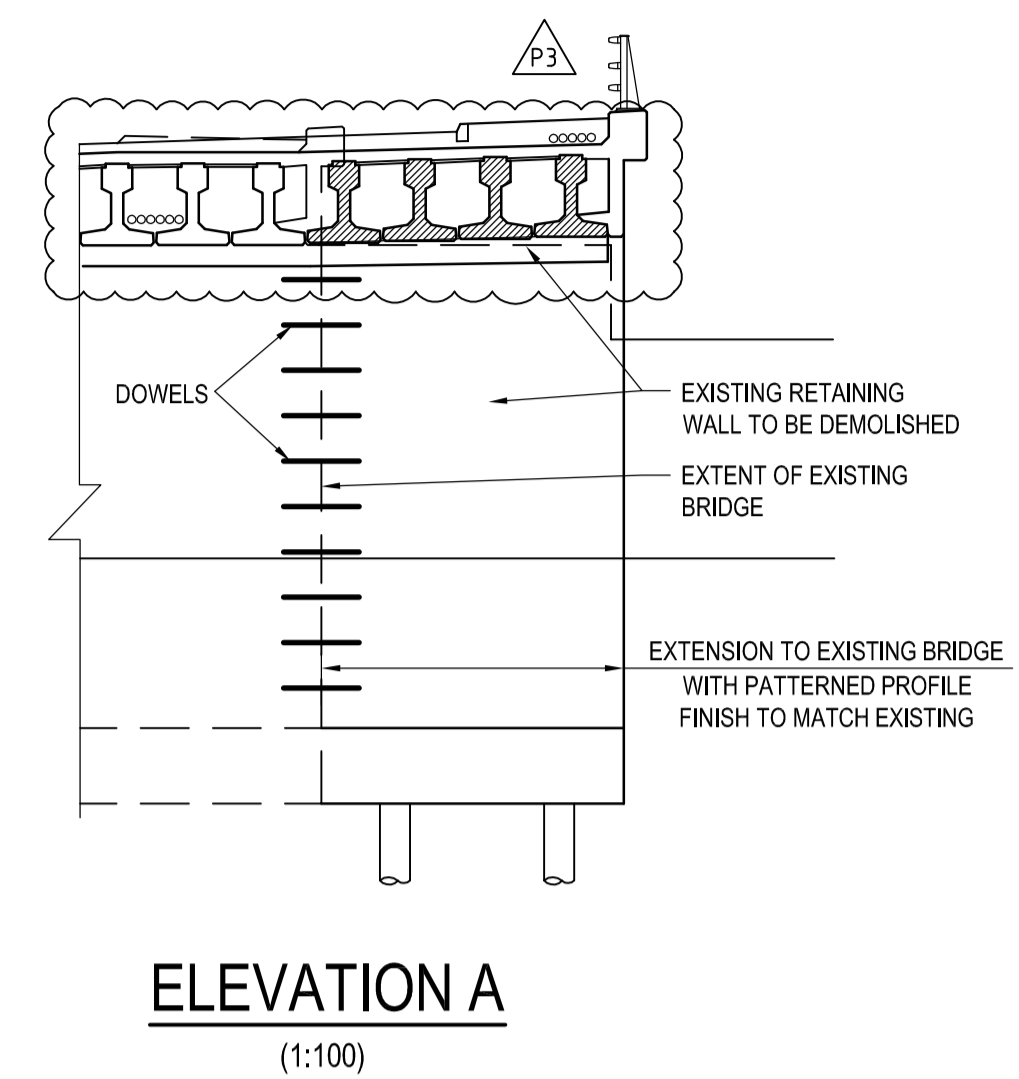
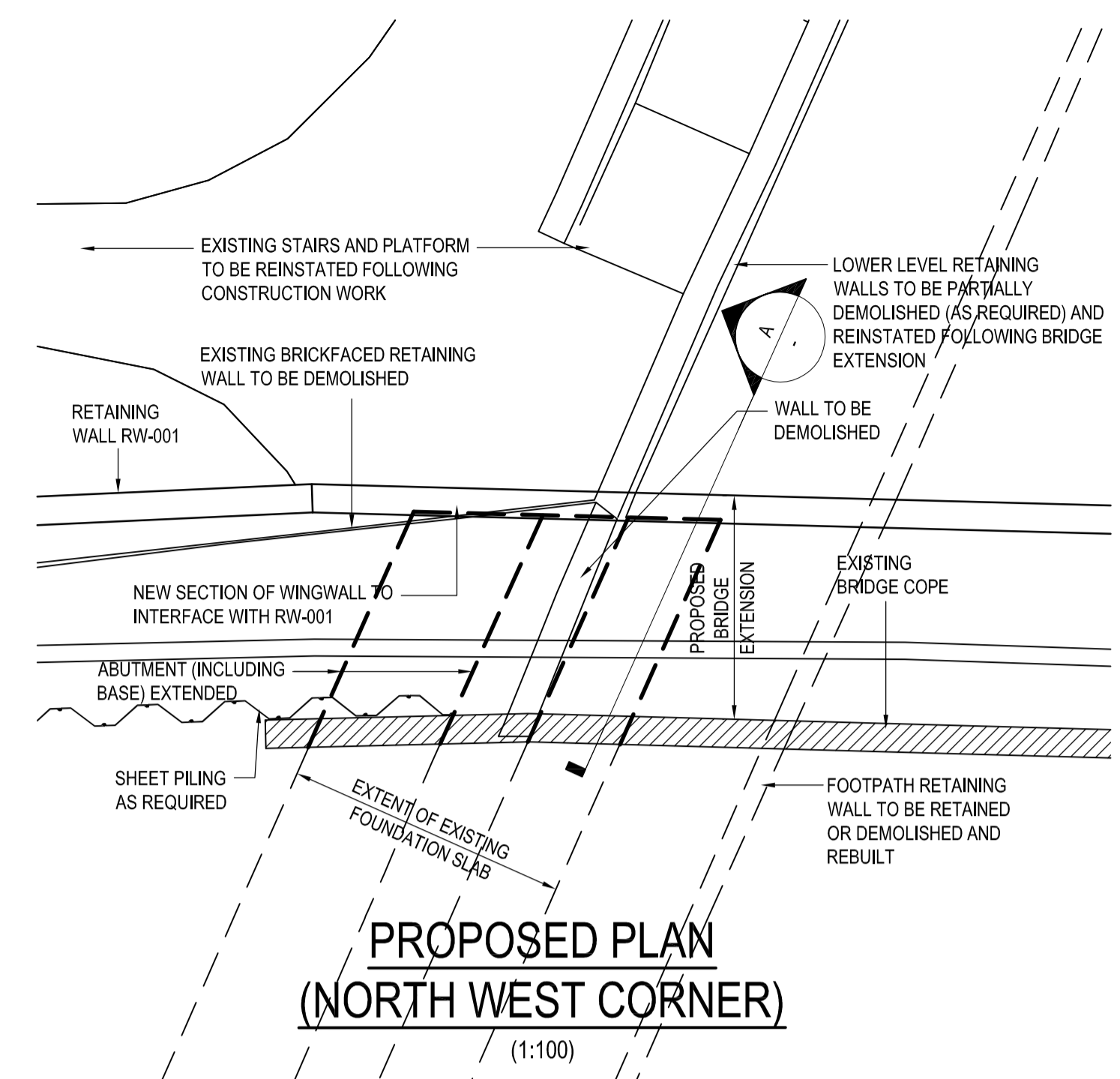

| Revision Details | By | Date | Scale |
|--|------|----------|-------|
| SURFACING UPDATED TO MATCH PROPOSED 125 MIN | JMcC | 16.04.14 | P3 |
| SERVICES SHOWN ON DECK | JMcC | 25.02.14 | P2 |
| RW-002 REMOVED. EXTENTS OF SHEET PILING REVISED. | DSH | 03.02.14 | P1 |

Purpose of issue: PRELIMINARY



Project Title: YORK STREET INTERCHANGE

Drawing Title: BRIDGE NO. BR-001 EXTENSION GENERAL ARRANGEMENT SHEET 2 OF 2

| Designated | Drawn | Checked | Approved | Date |
|------------|-------|---------|----------|------|
| DPB | DSH | DPB | | |

URS Internal Project No. _____ Suitability _____

Scale @ A1 _____ Zone _____

AS SHOWN

THIS DOCUMENT HAS BEEN PREPARED PURSUANT TO AND SUBJECT TO THE TERMS OF URS APPOINTMENT BY ITS CLIENT. URS ACCEPTS NO LIABILITY FOR ANY USE OF THIS DOCUMENT OTHER THAN BY ITS ORIGINAL CLIENT OR FOLLOWING URS' EXPRESS AGREEMENT TO SUCH USE, AND ONLY FOR THE PURPOSES FOR WHICH IT WAS PREPARED AND PROVIDED.

URS Infrastructure & Environment UK Limited
 Beech Hill House
 Beech Hill Road, Belfast
 BT8 7RP
 Tel: +44 (0)28 9070 5111
 Fax: +44 (0)28 9079 5951
 www.ursgroup.com



Drawing Number: YSI-URS-BR-01-DR-SE-00002 Rev: P3